

# RECIPE HOUSE - "SAVANNAH"

MODERN SKILLION DESIGN

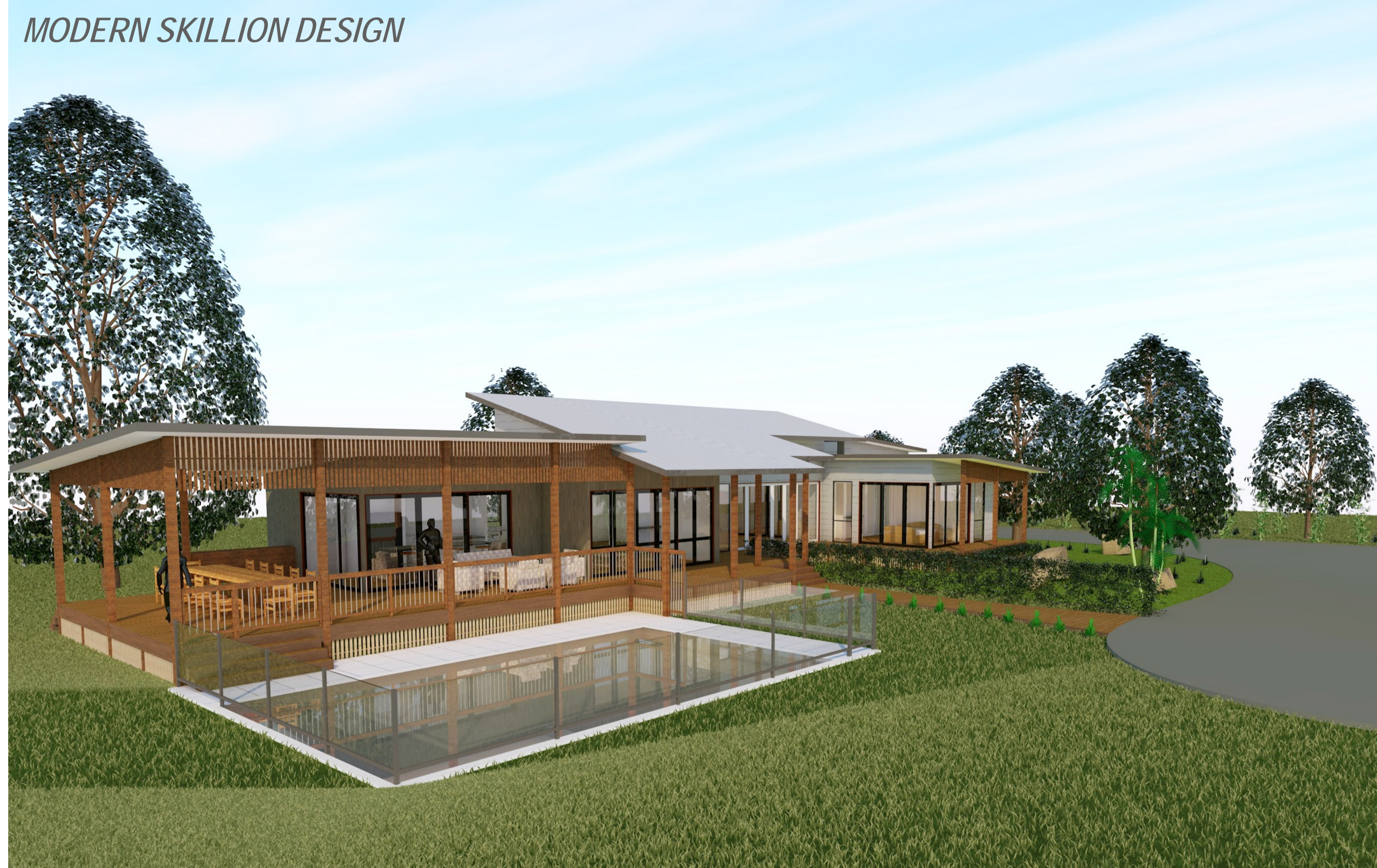

## FEAUTRES OF THIS SPACIOUS 4 BEDROOM HOME:

- Generous enough master bed
  - Ensuite
  - Walk in robe
- Open kitchen connected to outdoor areas
  - Butlers pantry
- Sprawling outdoor deck for the long country table as well as informal lounge with BBQ
- Vast multi-purpose breezeway / entertainment area
- Open plan spacious lounge, formal family dining room & multi-media
- Great variety of practical bathroom & wet area rooms
- Oversized double garage with workshop & storage with high doors & ceilings for rural vehicles
- Optional in ground pool for entertainment & cooling



1 ELEVATION

2 3D FLOOR PLAN

### SUSTAINABLE

PO BOX 132 BOOVAL QLD 4304  
 PH: 3201 1177  
 FAX: 3201 1133  
[www.sustainabledc.au](http://www.sustainabledc.au)

### GENERAL NOTES

- THESE DRAWINGS ARE THE COPYRIGHT OF SUSTAINABLE AND MAY NEVER BE USED, COPIED OR RETAINED WITHOUT WRITTEN CONSENT.
- DO NOT SCALE FROM THIS DRAWING. INSTEAD USE FIGURED DIMENSIONS. SETOUT DIMENSIONS ARE GENERALLY TO FACE OF STRUCTURAL ELEMENTS UNLESS NOTED OTHERWISE. CHECK ALL RELEVANT SETOUTS, LEVELS, SETBACKS, CRITICAL DIMENSIONS AND DETAILS ON SITE PRIOR TO AND DURING CONSTRUCTION. NOTIFY ANY DISCREPANCIES DISCOVERED BEFORE PROCEEDING.
- DOCUMENTATION TO BE READ IN CONJUNCTION WITH CONSULTING ENGINEERS DOCUMENTS.
- ALL CONSTRUCTION TO COMPLY WITH THE BUILDING CODE OF AUSTRALIA AND CURRENT AUSTRALIAN STANDARDS.

*"Savannah's" beauty is her ability to scale and adapt her footprint to your individual needs and requirements.*